

543455, US-1, CALLAHAN, FL 32011
CALLAHAN, NASSAU COUNTY, FLORIDA

Professional Engineer Seal for Lucas Carlo, State of Florida, License No. 61636. The seal is circular with a double border. The outer border contains the text "LUCAS CARLO" at the top and "PROFESSIONAL ENGINEER" at the bottom, separated by stars. The inner circle contains the text "STATE OF FLORIDA" at the top and "LICENSE NO. 61636" at the bottom, also separated by stars.

[illegible][illegible]

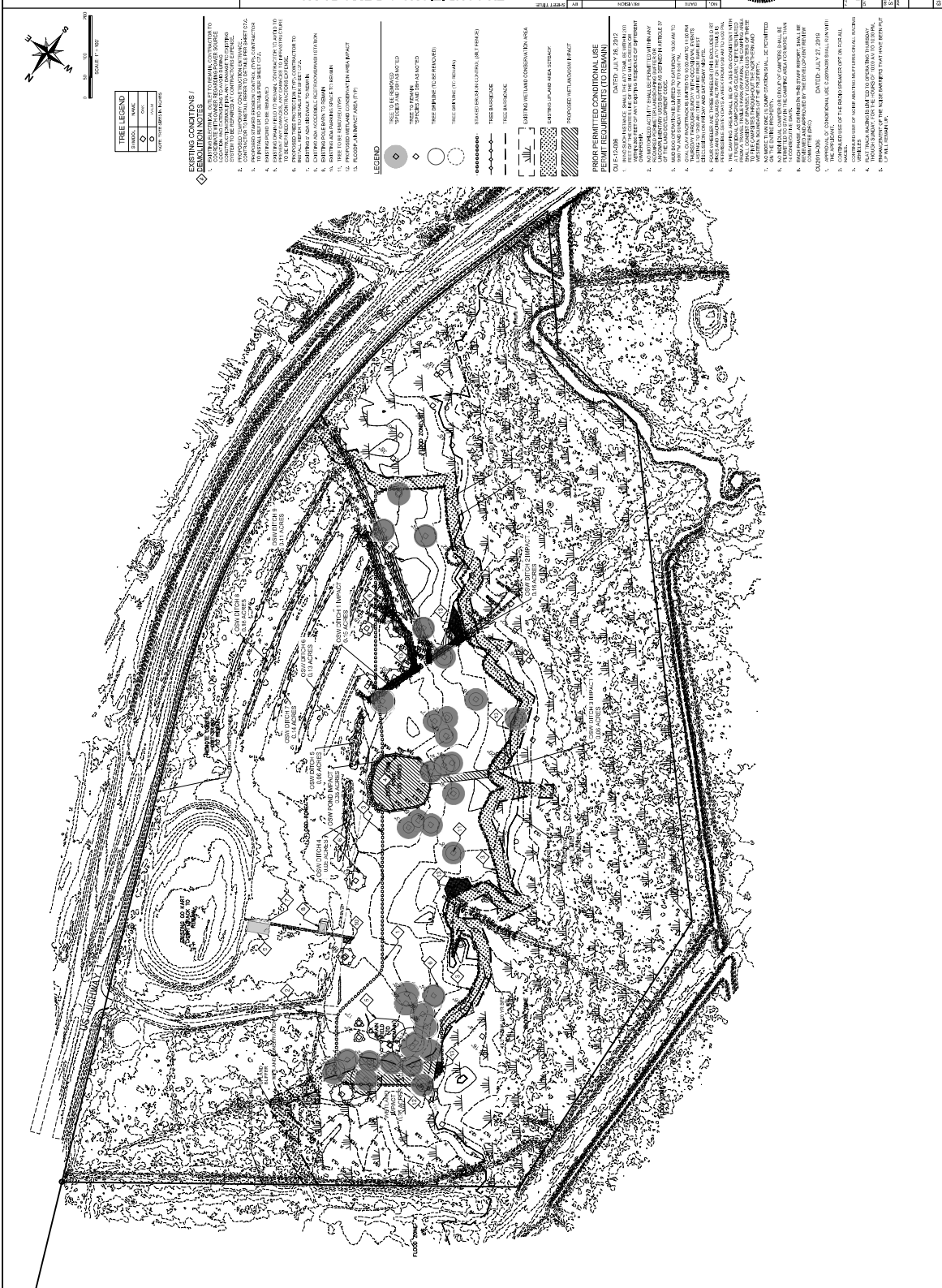

NO.	DATE	REVISION
1	01/15/2021	ISSUED FOR PERMITTING
2	02/01/2021	REVISED TO ADD NEW DITCHES
3	02/01/2021	REVISED TO ADD NEW DITCHES
4	02/01/2021	REVISED TO ADD NEW DITCHES
5	02/01/2021	REVISED TO ADD NEW DITCHES
6	02/01/2021	REVISED TO ADD NEW DITCHES
7	02/01/2021	REVISED TO ADD NEW DITCHES
8	02/01/2021	REVISED TO ADD NEW DITCHES
9	02/01/2021	REVISED TO ADD NEW DITCHES
10	02/01/2021	REVISED TO ADD NEW DITCHES

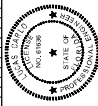

PROJECT NO.	543455
DATE	01/15/2021
BY	D.A.H.
CHECKED BY	D.A.H.
SCALE	AS SHOWN
PROJECT NAME	CALLAHAN SPEEDWAY EXPANSION
PROJECT LOCATION	543455, US-1, CALLAHAN, FL 32011
PROJECT OWNER	CALLAHAN SPEEDWAY
PROJECT DESCRIPTION	EXPANSION OF CALLAHAN SPEEDWAY
PROJECT STATUS	ISSUED FOR PERMITTING
PROJECT PHASE	DESIGN
PROJECT BUDGET	\$1,000,000
PROJECT RISK	LOW
PROJECT COMPLEXITY	MEDIUM
PROJECT CHALLENGES	WETLANDS, ENVIRONMENTAL
PROJECT SOLUTIONS	DITCHES, FILL
PROJECT OUTCOMES	EXPANSION OF SPEEDWAY
PROJECT LESSONS LEARNED	WETLANDS, ENVIRONMENTAL
PROJECT NEXT STEPS	CONSTRUCTION
PROJECT CONTACTS	D.A.H.
PROJECT REFERENCES	CALLAHAN SPEEDWAY
PROJECT NOTES	EXPANSION OF CALLAHAN SPEEDWAY





DATE	December 21, 2023
FROM	X & A
TO	12606C3001F
SUBJECT	TEL: 43.97
REMARKS	NAVD88
DATE	0/15/2023
TIME	4:17A.001
LOCATION	C5.0
STATUS	6 OF 15

STORM PIPE DATA			
PIPE RUN	LENGTH	DIA. & TYPE	SLOPE
ST-1 TO ST-2	148'	24" RCP	0.51%
ST-2 TO ST-3	77'	18" RCP	0.64%
ST-3 TO ST-4	38'	15" RCP	1.62%
ST-4 TO ST-5	72'	18" RCP	0.88%
ST-5 TO ST-6	26'	15" RCP	2.70%
ST-6 TO ST-7	130'	24" RCP	0.76%

[illegible]

GENERAL NOTES

1. CONTRACTOR TO INSTALL SIGNALES WITH MINIMUM DEPTH AS SPECIFIED
2. CONTRACTOR TO BLOKE SIGNALES TO PROMOTE DRAINAGE TOWARDS PROPOSED POND OR ASSOCIATED INLET STRUCTURE AND AS NECESSARY TO PREVENT BROUIN ROUT SUGLER FILETS.
3. CONTRACTOR TO INSTALL PROPOSED POND AS SPECIFIED WITH A 1:1 SLOPE

EXISTING SPOT ELEVATION	PROPOSED FLOODPLAIN COMPENSATION AREA
14.3	

000000000000 STAFFED EDUCATION CONTRACT (SILT PERIOD)

LAKE/POD EXCAVATION NOTE:

NO EXCAVATION SHALL EXTEND BELOW THE PERMITTED DEPTHS DISPLAYED, OR BEYOND THE SHORELINE OR THE REMAINING ADJACENT, TENDING OR PROTECTIVE, ELEVATION, AND NO COMPLETION OF THE PROJECT SHALL BE ALLOWED UNTIL THE PROJECT HAS BEEN COMPLETED AND THE PROJECT HAS BEEN COMPLETED AND THE PROJECT HAS BEEN COMPLETED.

[illegible]

TREE LEGEND	
SYMBOL	NAME
	GAK
	PALM

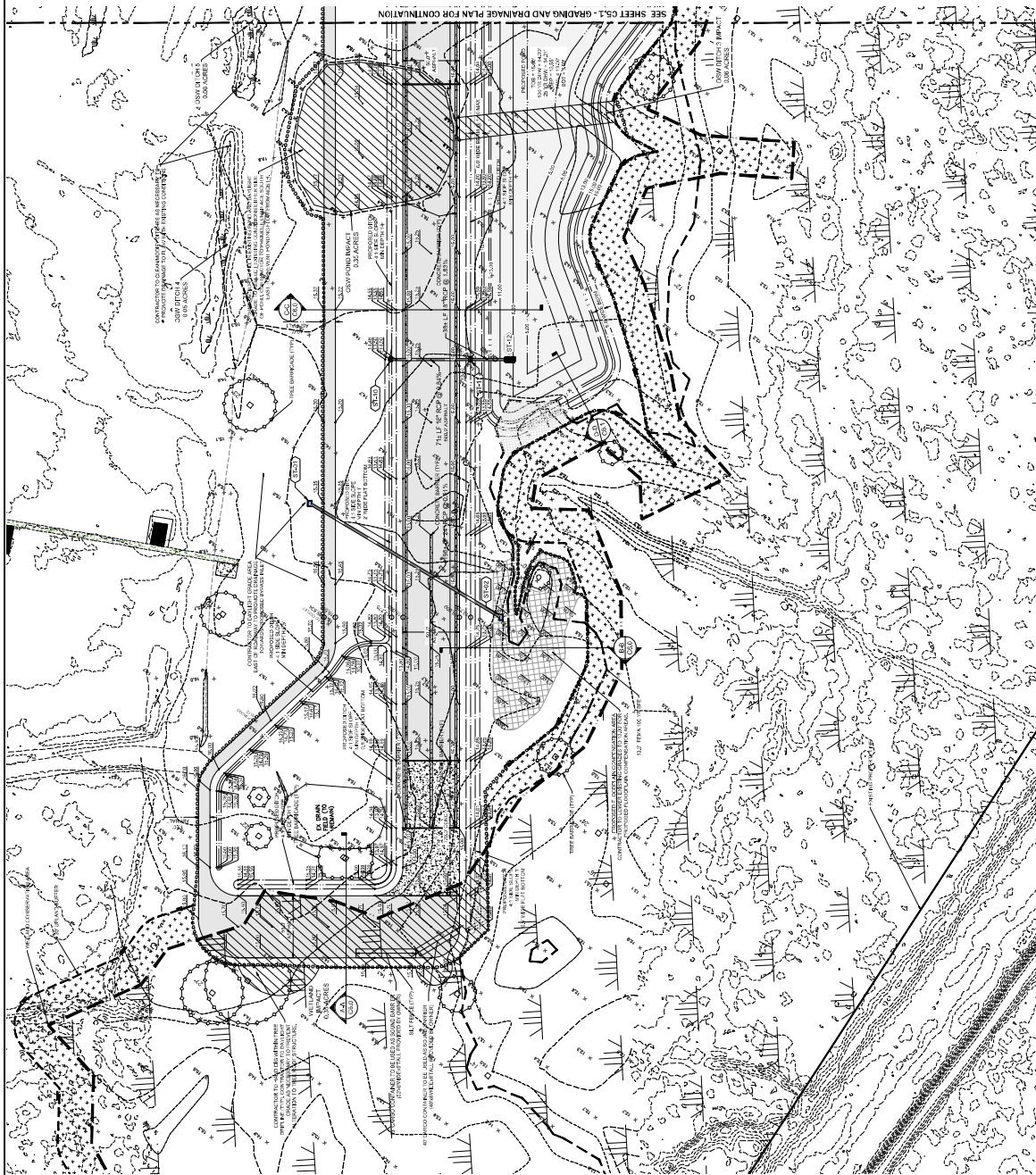

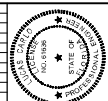

NO. 22860	PRIN. NO.
X & A	1006-C1001F
CL. 53.37	DATE 12/10/14
NAVD88	
TEMP. 7	DATE 6/15/2023
7 T24 R25E	
4174.001	
C5.1	

7 of 15

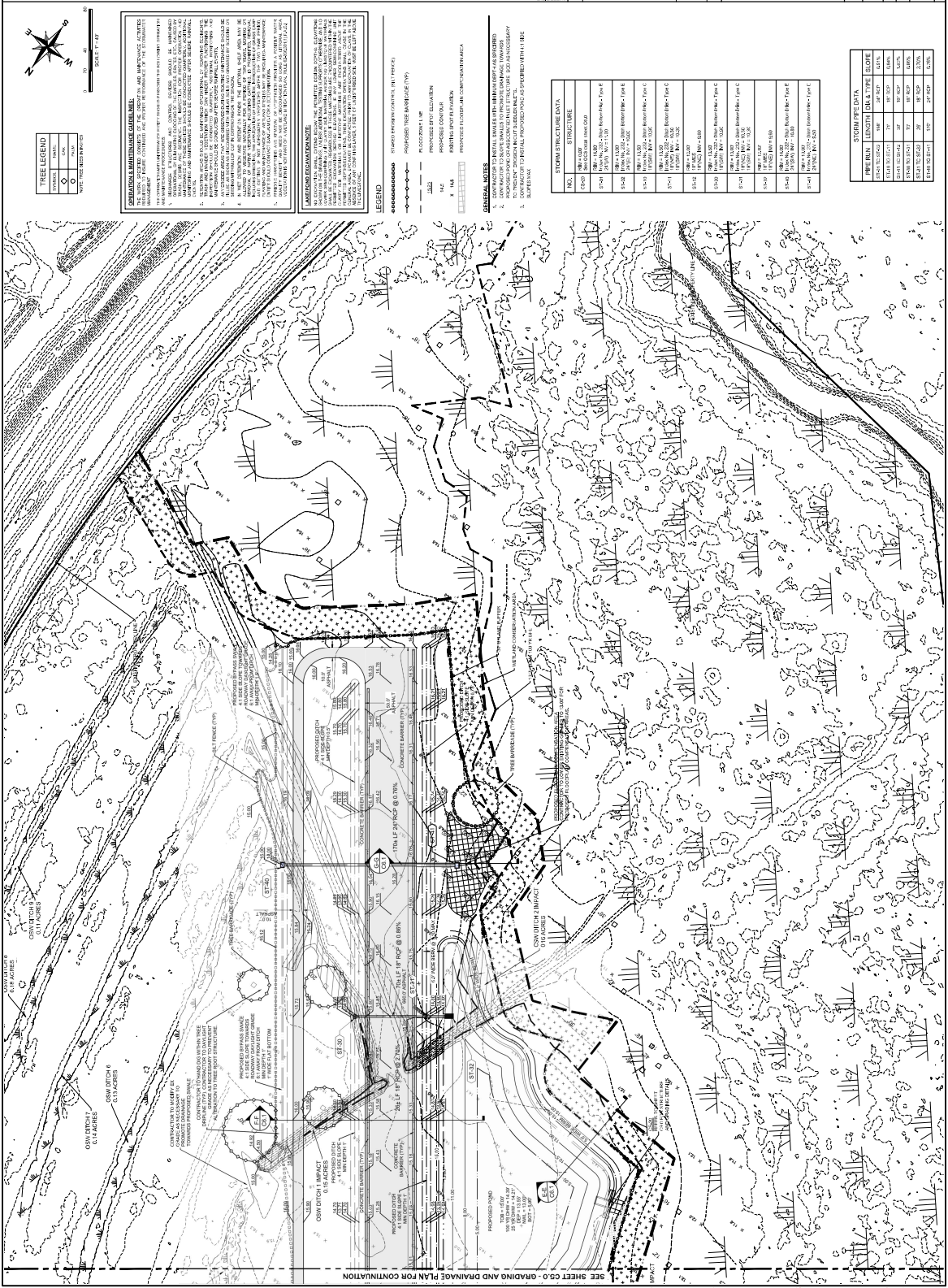

STORM STRUCTURE DATA		STRUCTURE
NO.	NO.	
00000	00000	NO. 1-0000 - Storm Station 0-0000 - Type C
00001	00001	NO. 1-0001 - Storm Station 0-0001 - Type C
00002	00002	NO. 1-0002 - Storm Station 0-0002 - Type C
00003	00003	NO. 1-0003 - Storm Station 0-0003 - Type C
00004	00004	NO. 1-0004 - Storm Station 0-0004 - Type C
00005	00005	NO. 1-0005 - Storm Station 0-0005 - Type C
00006	00006	NO. 1-0006 - Storm Station 0-0006 - Type C
00007	00007	NO. 1-0007 - Storm Station 0-0007 - Type C
00008	00008	NO. 1-0008 - Storm Station 0-0008 - Type C
00009	00009	NO. 1-0009 - Storm Station 0-0009 - Type C
00010	00010	NO. 1-0010 - Storm Station 0-0010 - Type C
00011	00011	NO. 1-0011 - Storm Station 0-0011 - Type C
00012	00012	NO. 1-0012 - Storm Station 0-0012 - Type C
00013	00013	NO. 1-0013 - Storm Station 0-0013 - Type C
00014	00014	NO. 1-0014 - Storm Station 0-0014 - Type C
00015	00015	NO. 1-0015 - Storm Station 0-0015 - Type C
00016	00016	NO. 1-0016 - Storm Station 0-0016 - Type C
00017	00017	NO. 1-0017 - Storm Station 0-0017 - Type C
00018	00018	NO. 1-0018 - Storm Station 0-0018 - Type C
00019	00019	NO. 1-0019 - Storm Station 0-0019 - Type C
00020	00020	NO. 1-0020 - Storm Station 0-0020 - Type C
00021	00021	NO. 1-0021 - Storm Station 0-0021 - Type C
00022	00022	NO. 1-0022 - Storm Station 0-0022 - Type C
00023	00023	NO. 1-0023 - Storm Station 0-0023 - Type C
00024	00024	NO. 1-0024 - Storm Station 0-0024 - Type C
00025	00025	NO. 1-0025 - Storm Station 0-0025 - Type C
00026	00026	NO. 1-0026 - Storm Station 0-0026 - Type C
00027	00027	NO. 1-0027 - Storm Station 0-0027 - Type C
00028	00028	NO. 1-0028 - Storm Station 0-0028 - Type C
00029	00029	NO. 1-0029 - Storm Station 0-0029 - Type C
00030	00030	NO. 1-0030 - Storm Station 0-0030 - Type C
00031	00031	NO. 1-0031 - Storm Station 0-0031 - Type C
00032	00032	NO. 1-0032 - Storm Station 0-0032 - Type C
00033	00033	NO. 1-0033 - Storm Station 0-0033 - Type C
00034	00034	NO. 1-0034 - Storm Station 0-0034 - Type C
00035	00035	NO. 1-0035 - Storm Station 0-0035 - Type C
00036	00036	NO. 1-0036 - Storm Station 0-0036 - Type C
00037	00037	NO. 1-0037 - Storm Station 0-0037 - Type C
00038	00038	NO. 1-0038 - Storm Station 0-0038 - Type C
00039	00039	NO. 1-0039 - Storm Station 0-0039 - Type C
00040	00040	NO. 1-0040 - Storm Station 0-0040 - Type C
00041	00041	NO. 1-0041 - Storm Station 0-0041 - Type C
00042	00042	NO. 1-0042 - Storm Station 0-0042 - Type C
00043	00043	NO. 1-0043 - Storm Station 0-0043 - Type C
00044	00044	NO. 1-0044 - Storm Station 0-0044 - Type C
00045	00045	NO. 1-0045 - Storm Station 0-0045 - Type C
00046	00046	NO. 1-0046 - Storm Station 0-0046 - Type C
00047	00047	NO. 1-0047 - Storm Station 0-0047 - Type C
00048	00048	NO. 1-0048 - Storm Station 0-0048 - Type C
00049	00049	NO. 1-0049 - Storm Station 0-0049 - Type C
00050	00050	NO. 1-0050 - Storm Station 0-0050 - Type C
00051	00051	NO. 1-0051 - Storm Station 0-0051 - Type C
00052	00052	NO. 1-0052 - Storm Station 0-0052 - Type C
00053	00053	NO. 1-0053 - Storm Station 0-0053 - Type C
00054	00054	NO. 1-0054 - Storm Station 0-0054 - Type C
00055	00055	NO. 1-0055 - Storm Station 0-0055 - Type C
00056	00056	NO. 1-0056 - Storm Station 0-0056 - Type C
00057	00057	NO. 1-0057 - Storm Station 0-0057 - Type C
00058	00058	NO. 1-0058 - Storm Station 0-0058 - Type C
00059	00059	NO. 1-0059 - Storm Station 0-0059 - Type C
00060	00060	NO. 1-0060 - Storm Station 0-0060 - Type C
00061	00061	NO. 1-0061 - Storm Station 0-0061 - Type C
00062	00062	NO. 1-0062 - Storm Station 0-0062 - Type C
00063	00063	NO. 1-0063 - Storm Station 0-0063 - Type C
00064	00064	NO. 1-0064 - Storm Station 0-0064 - Type C
00065	00065	NO. 1-0065 - Storm Station 0-0065 - Type C
00066	00066	NO. 1-0066 - Storm Station 0-0066 - Type C
00067	00067	NO. 1-0067 - Storm Station 0-0067 - Type C
00068	00068	NO. 1-0068 - Storm Station 0-0068 - Type C
00069	00069	NO. 1-0069 - Storm Station 0-0069 - Type C
00070	00070	NO. 1-007

STORM PIPE DATA			
PIPE RUN	LENGTH	DA & TYPE	SLOPE
ST-1 TO ST-2	148'	24" RCP	0.61%
ST-2 TO ST-3	77'	18" RCP	0.84%
ST-3 TO ST-4	38'	18" RCP	1.02%
ST-4 TO ST-5	72'	18" RCP	0.89%
ST-5 TO ST-6	29'	18" RCP	2.10%
ST-6 TO ST-7	130'	24" RCP	0.76%



1. I certify that the above report was prepared by me or under my direct supervision and that I am a duly qualified and licensed professional engineer. 2. I certify that the above report was prepared by me or under my direct supervision and that I am a duly qualified and licensed professional engineer. 3. I certify that the above report was prepared by me or under my direct supervision and that I am a duly qualified and licensed professional engineer.	DATE: 12/15/2023 TIME: 10:00 AM LOCATION: 10000 100TH AVE, SUITE 100, FARMINGTON, NM 87403 PROJECT: 10000 100TH AVE, SUITE 100, FARMINGTON, NM 87403 DRAWING: 10000 100TH AVE, SUITE 100, FARMINGTON, NM 87403 SCALE: 1/4" = 1'-0" SHEET: 8 OF 15
---	---

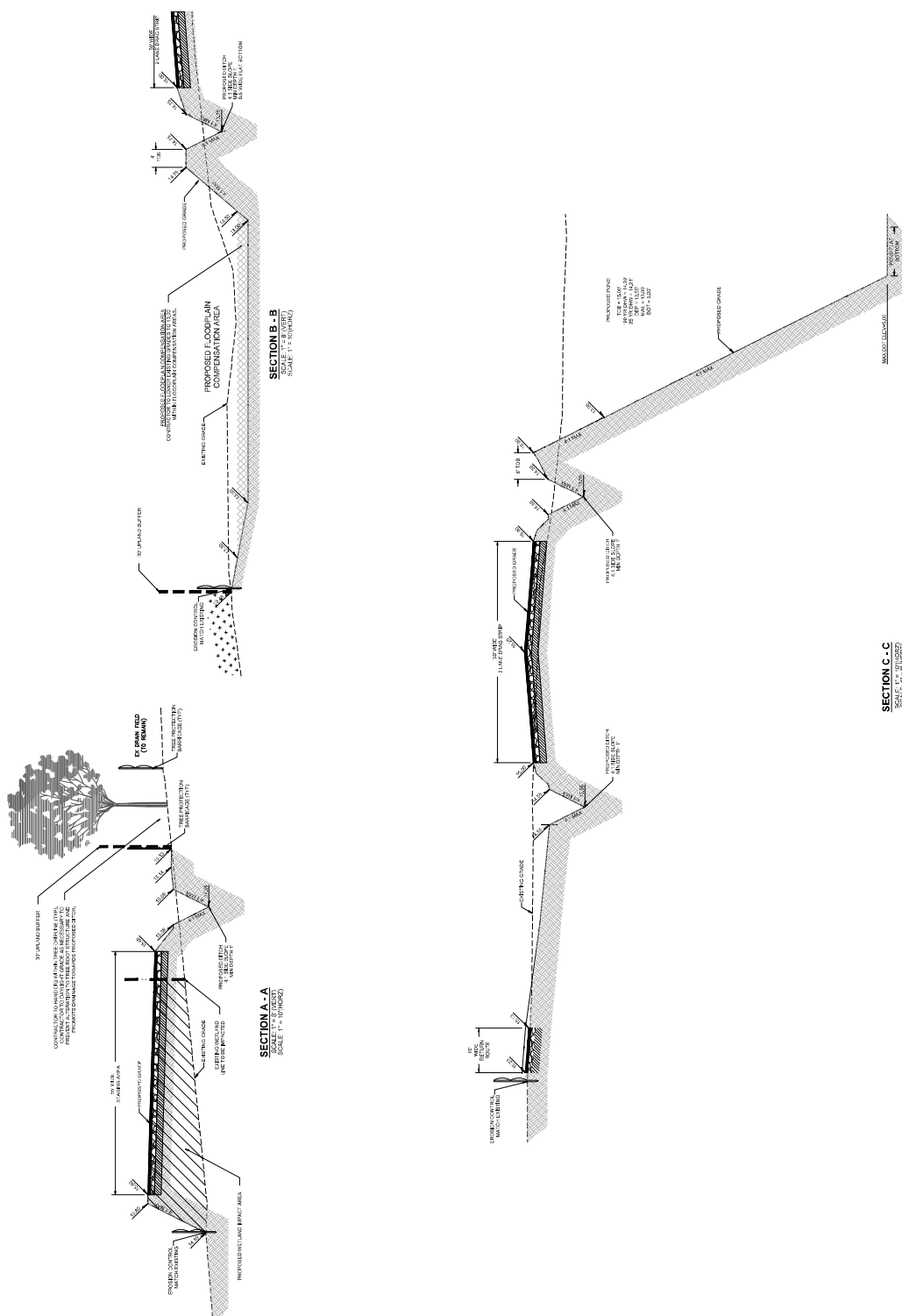

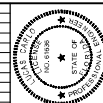

1. I certify that the above information is true and correct to the best of my knowledge and belief. 2. I understand that this information is being provided to the Department of Defense for the purpose of determining the eligibility of the applicant for a security clearance. 3. I understand that this information is being provided to the Department of Defense for the purpose of determining the eligibility of the applicant for a security clearance. 4. I understand that this information is being provided to the Department of Defense for the purpose of determining the eligibility of the applicant for a security clearance.	December 21, 2023 X & A 1200602001F 1211 11:30 1211 11:30 1211 11:30	NAVD88 DATE: 6/19/2023 4174.001	C6.1 SET 9 OF 15
---	---	---------------------------------------	---------------------

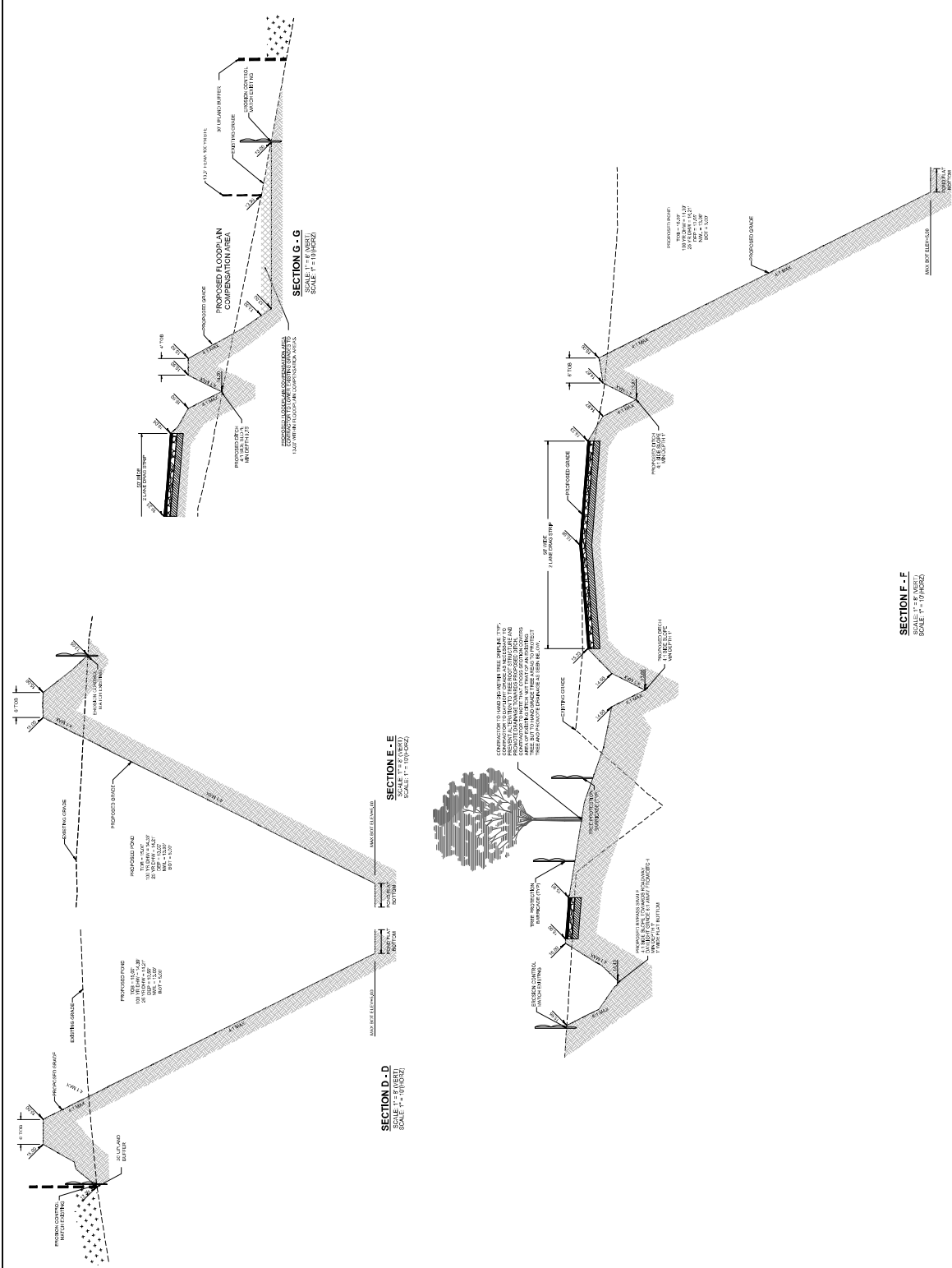

EROSION CONTROL DETAILS

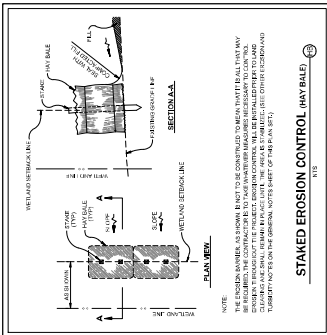
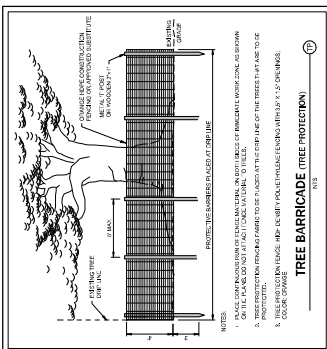
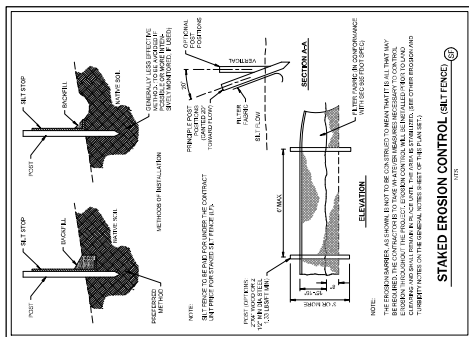
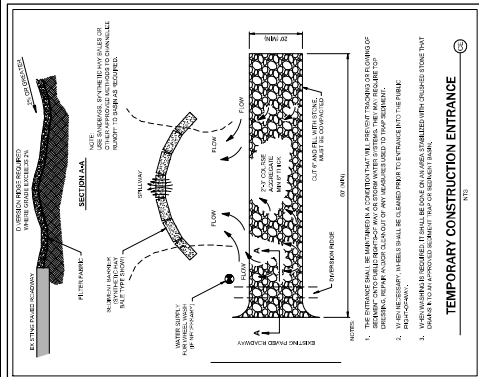
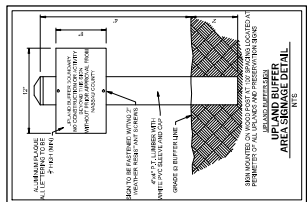
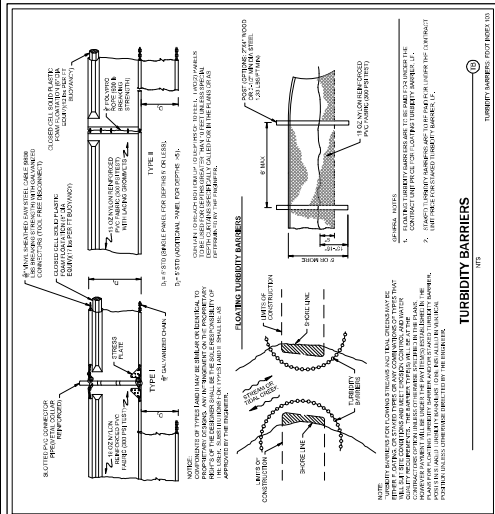

SITE DETAILS

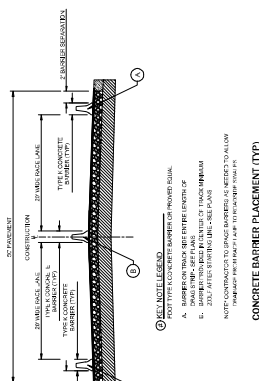

OPTION 1		
STRUCTURAL NUMBER		
COURSE	CREDIT HRS	EN
SP-22.5	3	0.54
SPUR 103	3	0.54
CONCRETE 242	3	0.54
CONCRETE 247	3	0.54
STEEL 242	3	0.54

GENERAL NOTES

ALL DIMENSIONS SHOWN ARE MINIMUM. CONTRACTOR TO COORDINATE WITH OWNER REGARDING ANY CHANGES OR INCREASES TO PAVEMENT SECTION.

CONTRACTOR TO PROVIDE 2" GRAVEL SHOULDER WHERE SHOWN.

CONTRACTOR TO SOO SHOULDS UNDER ANY IS" CURB AND DURING

KEY NOTE LEGEND

- 1. 3" SP-4.5 ASPHALT PAVEMENT
- 2. 18" CRUSHED CONCRETE BASE
- 3. 3" TYPE 'B' STABILIZATION ILR 40
- 4. 2" GRAVEL SHOULDER
- 5. 4:1 ROMPOTE CRUSHED GRAVEL

CONCRETE PAVEMENT SECTION

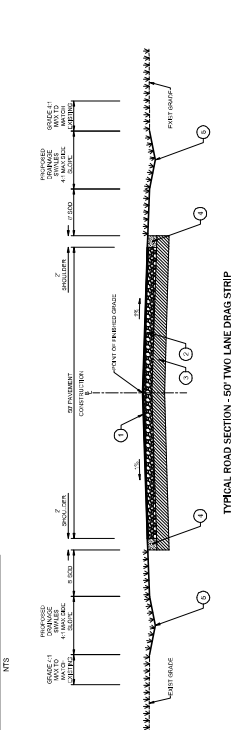

TYPICAL ROAD SECTION - 50' TWO LANE DRAG STRIP

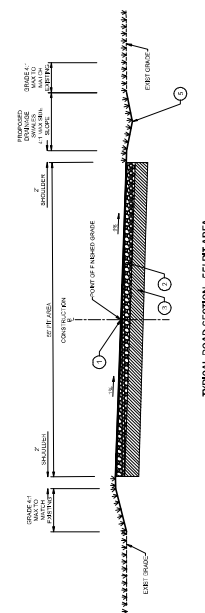

TYPICAL ROAD SECTION - 55' PIT AREA

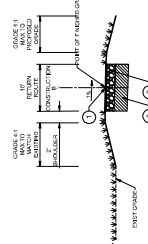

TYPICAL ROAD SECTION -10' RETURN ROUTE

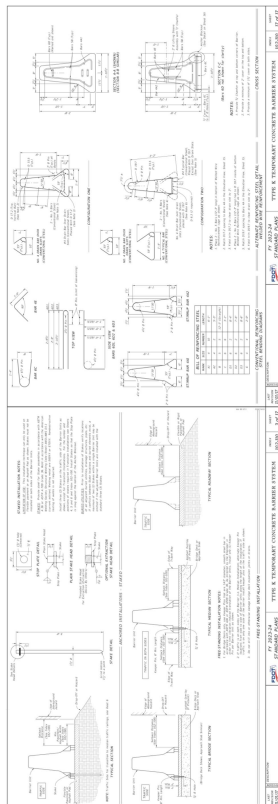

Development Review General Notes:

- [illegible]

DEVELOPMENT REVIEW
GENERAL NOTES

ADWAY AND DRAINAGE STANDARDS	REVISION DATES
NASSAU COUNTY	
ENGINEERING SERVICES DEPARTMENT	

NOTE SHEET: 1
DWG:

VEHICLE CONSTRUCTION NOTES:

- [illegible]

THE MATERIAL: CRUSHED CONCRETE

- [illegible]

SOIL CEMENT ROAD BASE MATERIAL SHOULD MEET THE FOLLOWING CONDITIONS:

- [illegible]

LANDSCAPE PLAN

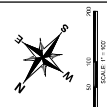

- [illegible]



LANDSCAPE REQUIREMENTS

1. 25 FOOT PERMETER LANDSCAPE STRIP ALONG US HWY 1, CONTRACTOR SHALL REMOVE THESE CROPS AND THREE UNDER STORY TREES PER 100 LINEAR FEET.
2. 6' HIGH VINYL FENCE OR APPROVED EQUAL PER MASSACHUSETTS MUNICIPAL ORDER 2002-24, COMBINATION 10 BELL AUSTIN 14-202, AS SPECIFIED AND APPROVED BY THE TOWN ENGINEER.

LEGEND

EXISTING VEGETATION MEETS THE APPLICABLE
LANDSCAPING REQUIREMENTS OF THE LDC

IF HIGHWAY FENCE OR PROVIDED BERM.

PLANT SCHEDULE					
INLES	QTY	BOTANICAL NAME	COMMON NAME	SIZE	HEIGHT
	7	CESTRA VICTORIANA	LEE OAK	3' CAL	14 IN X 8 SPD
	6	REASOMPUS OCEPENS	JAPANESE BLUEBERRY	3' CAL	14 IN X 8 SPD

